

Aircraft Support Equipment



Baggage Tow Tractor Model MA

The MA is a time-tested, field proven tow tractor with 3,000 to 6,000 pounds (1,362 to 2,722 kg) drawbar pull to handle all of your cargo and baggage towing requirements and to provide pushback for private and regional aircraft with a MTOW up to 60,000 pounds (27,220 kg). All models are equipped with gasoline-, diesel-, LPG- or CNG-fueled engines. An enclosed cabin and other options are available.

Other features include solid-state ignition, engine emission control, automatic transmission and disc brakes on the rear wheels operated via a dual hydraulic system. Simple, rugged and easy access to all components assure long life on even the most demanding ramps.

Standard features include:

- Recessed headlights
- Combination tail and stop lights
- Power boosted disc brake system
- Automatic transmission
- Seat belts
- Non slip surface on floor boards
- Non slip surface on brake pedal
- Engine speed governor
- Adjustable over center park brake lever
- Split braking systems
- Front, rear & side reflectors

Stewart & Stevenson TUG – Kennesaw

2652 So. Main Street P.O. Box 1447
Kennesaw, GA 30144-8447 USA
Tel: (770) 422-7230 • Fax: (770) 428-7315
TUG Shop: (800) 989-8499 • (770) 422-8021

Stewart & Stevenson TUG – Houston

4516 Harrisburg Blvd. Houston, TX 77011 USA
Tel: (713) 923-0372 • (800) 231-0463

<http://www.sstug.com>



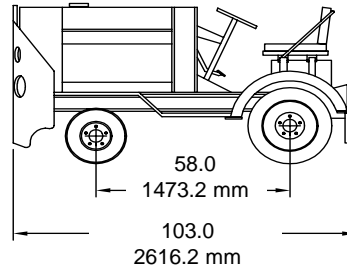
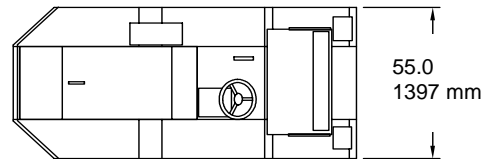
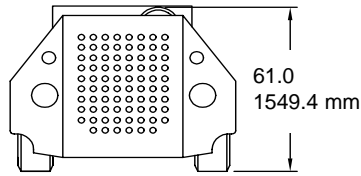

Specifications

Model MA

Dimensions

Length excluding coupler 103" (2616.2 mm)
 Width 57.5" (1460.5 mm)
 Height less cab 60" (1524.0 mm)
 Height with cab 82.5" (2095.5 mm)
 Wheelbase 59" (1498.6 mm)
 Minimum ground clearance. 6.5" (165.1 mm)
 Steer axle underclearance 7.8" (198.12 mm)
 Frame underclearance 10" (254.0 mm)
 Turning radius 115" (2921.0 mm)
 Maximum governed speed . . . 15 mph (24.14 kph)

Drawbar Pull by Model

Model	Drawbar Pull	GVW
MA 30	3000 lb (1362 kg)	3750 lb
MA 40	4000 lb (1816 kg)	5000 lb
MA 50	5000 lb (2270 kg)	6250 lb
MA 60	6000 lb (2722 kg)	7500 lb

Engine Options

Ford 300 Gasoline

Type In-line, 6 cylinder
 Fuel No-lead regular, 87 octane
 Bore & stroke 4 x 3.96" (101.6 x 100.6 mm)
 Displacement 300 CID (4.9 L)
 Governed rpm with full load 2500
 Net brake hp at governed rpm 95
 Torque at 2000 rpm 240 lb ft (325 Nm)
 Compression ratio 7.9:1
 Oil capacity Dry 7 qt (6.62 L)
 Refill 6 qt (5.68 L)
 Idle speed rpm 500 - 550

Perkins 1004 Diesel

Type In-line, 4 cylinder
 Fuel Diesel or Jet A
 Displacement 243 CID - 4 Liter
 Governed rpm 2500
 Net brake hp at governed rpm 86
 Torque at 1600 rpm 206 lb ft (279 Nm)
 Compression ratio 16.5:1
 Idle speed rpm 850

Cummins B 3.9

Type Water-cooled, direct injected
 4-cyl., in-line diesel engine
 Fuel Diesel or Jet A
 Bore & stroke 4.02 x 4.72" (102 x 120 mm)

Displacement 3.9 L
 Governed rpm with full load 2500
 Net brake hp at governed rpm 80
 Torque at 2000 rpm 189 lb ft (256 Nm)
 Compression ratio 18.5:1
 Idle speed rpm 750

Transmission

Gasoline

Type Ford industrial 2-speed automatic transmission w/torque converter

Diesel

Type Ford industrial 3-speed automatic transmission w/torque converter

Drive Axle

Type Heavy-duty 6,000 lb capacity axle with drop box

Drive Shaft

Type Double universal, sliding spline coupling

Electrical System

Type 12 V, negative ground
 Alternator 60 A

Cooling System

Engine 15 qt (14.2 L)
 Heavy-duty radiator and fan
 Transmission Radiator cooled

Fuel System

Fuel Cell Capacity 15.5 U.S. gal (58.67 L)
 Fuel options Gasoline, diesel, LP or CNG

Brakes System

Service Dual split system, vacuum boosted with four calipers on the rear axle and 13-inch cast iron rotors
 Parking Lever operated, drum type

Steering System

Type Ball and screw gearbox, heavy-duty front steer axle with inclined king pins, bushings and bearings

Suspension

Front Leaf springs
 Rear Rubber mount

Tires

Front 20.5 x 8 x 10,6-ply rating
 Rear 8 x 16.5, 8-ply rating

Hitch

Standard "E" hitch Other options available

Instruments

Water temperature
 Oil pressure
 Ammeter
 Hour meter

Options

Cab
 Overhead guard
 Backup alarm
 Snow plow
 Additional hitches to fit customer specifications
 Others available upon request

Stewart & Stevenson TUG – Kennesaw

2652 So. Main Street P.O. Box 1447

Kennesaw, GA 30144-8447 USA

Tel: (770) 422-7230 • Fax: (770) 428-7315

TUG Shop: (800) 989-8499 • (770) 422-8021

Stewart & Stevenson TUG – Houston

4516 Harrisburg Blvd. Houston, TX 77011 USA

Tel: (713) 923-0372 • (800) 231-0463

<http://www.sstug.com>



TUG